

## Wooden Door Hanging Rollers Sliding Accessories

Accessories	Qty	Accessories	Qty	Accessories	Qty
Wooden door top hung components	2	Damper stopper	2	Wooden door damper	2
Positioning plate	1	2mm allen key	1	ST4*16 cross countersunk head tapping screws	8

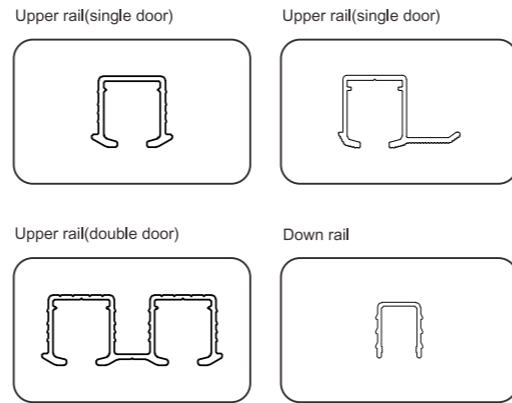

## 1. Cabinet size

Installation parameters: maximum door weight: 15kg,  
minimum door width: 520mm, minimum door thickness: 16mm.

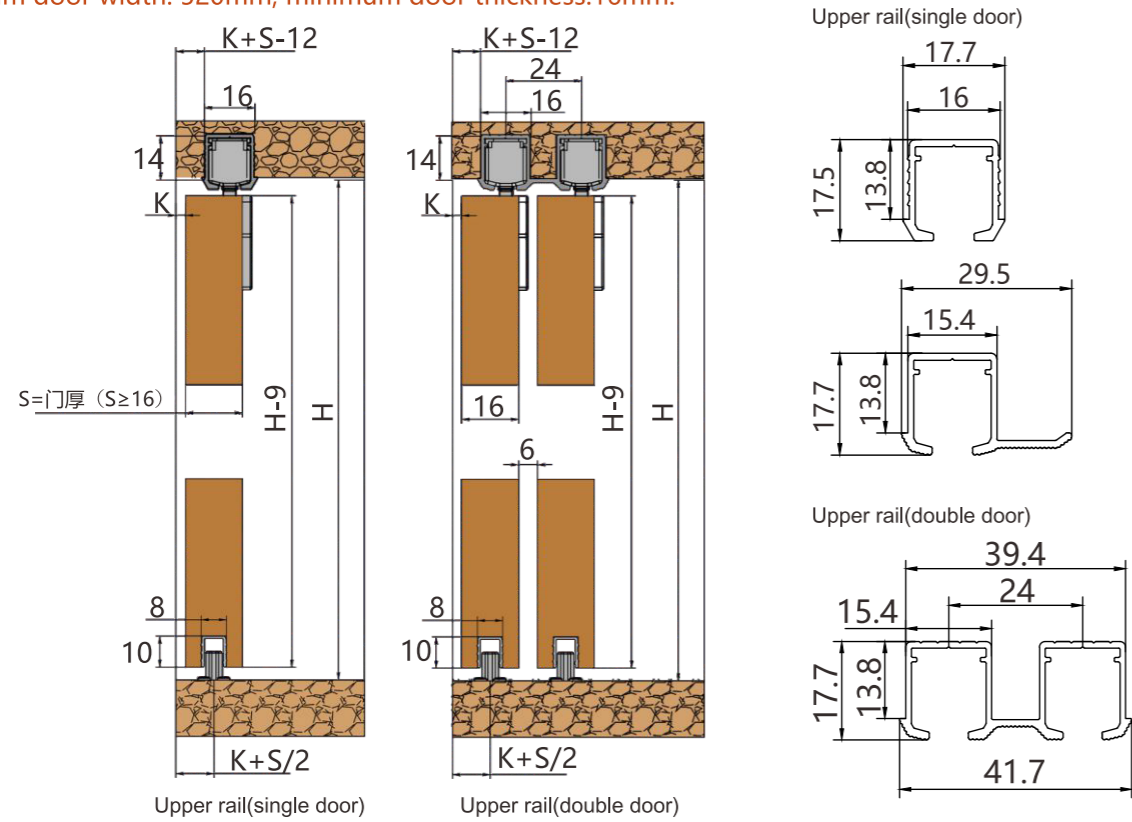

## 2. Drilling dimension

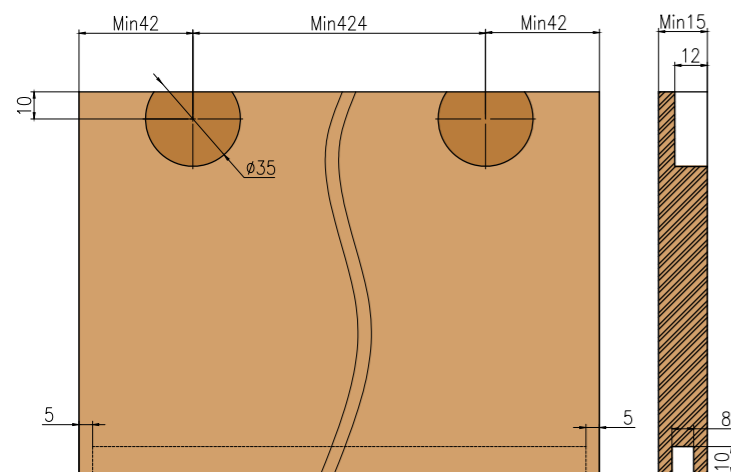

The minimum thickness of upper and lower board of single layer cabinet can be 18mm.

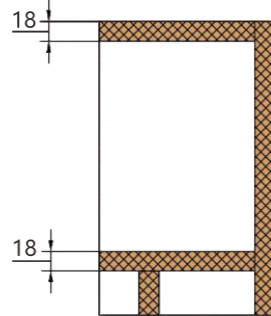

The thickness of the upper and lower layers of double layer cabinets can be 18mm, and the minimum thickness of the middle plate should be 25mm.

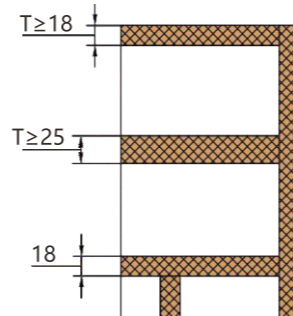

## 3. Install stopper and damper

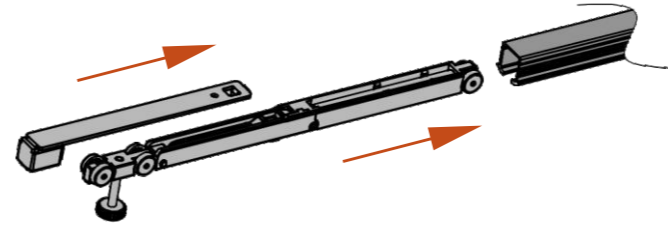

## 4. Install rail and positioning plate

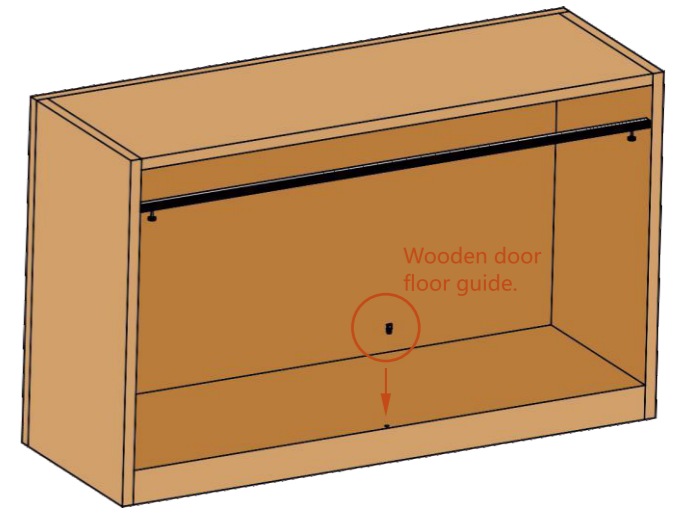

## 5. Drill holes on the door, install top hung components and down rail

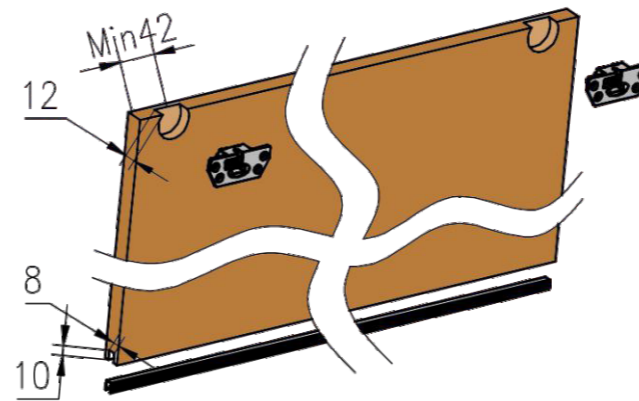

## 6. Install the door

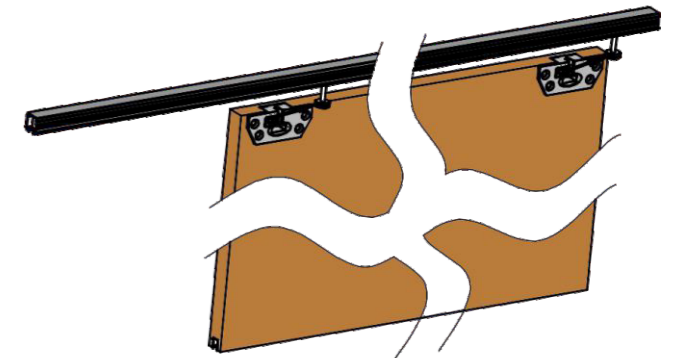

## 7. Adjust stopper to let the damper run completely and then close the door

